

How do I...install a fence?

Information needed for HDC review (only)

Note: BSEED requirements are not included below

1. Provide a picture of the house and site, showing the area(s) where the fence will be installed.
Photos here are for illustrative purposes only; photos must be 4x6 or larger



2. Provide information within all the highlighted portions of the building permit application.

3. Provide written scope of work:

- Catalog cut (or photo from the manufacturer's website) showing the style of fence to be installed. Please include material, finish color, and height.

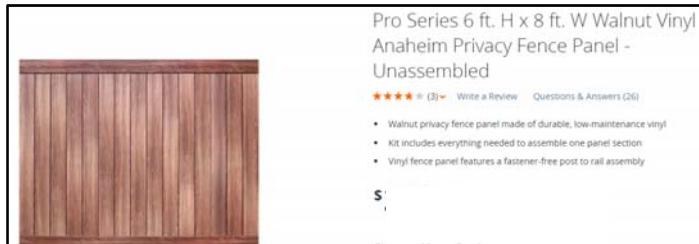

- Site plan (can be hand drawn, or an aerial image from Google maps can be used) – showing the exact location of the fence.

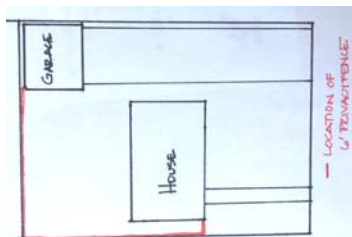

Refer to the Commission's **Fence Guidelines** for the styles of fences that can be approved, along with the location and height allowed for fences.

